

REV.	ECO/DDC	DESCRIPTION	DATE	DRAFT	CHECK	APV'D
A	----	RELEASED.	03-16-17	V.J.C.	E.M.J.	V.J.C.
B	12044	REVISED PER ECN.	12-19-19	V.J.C.	J.I.	V.J.C.
C	12142	REVISED PER ECN.	05-01-23	V.J.C.	J.M.	V.J.C.

## JUNCTION BOX FIELD WIRING TERMINAL BLOCKS

LOAD POINT 2 (LOAD CELL 2)  
LOAD POINT 3 (LOAD CELL 3)  
LOAD POINT 1 (LOAD CELL 1)  
LOAD POINT 4 (LOAD CELL 4)

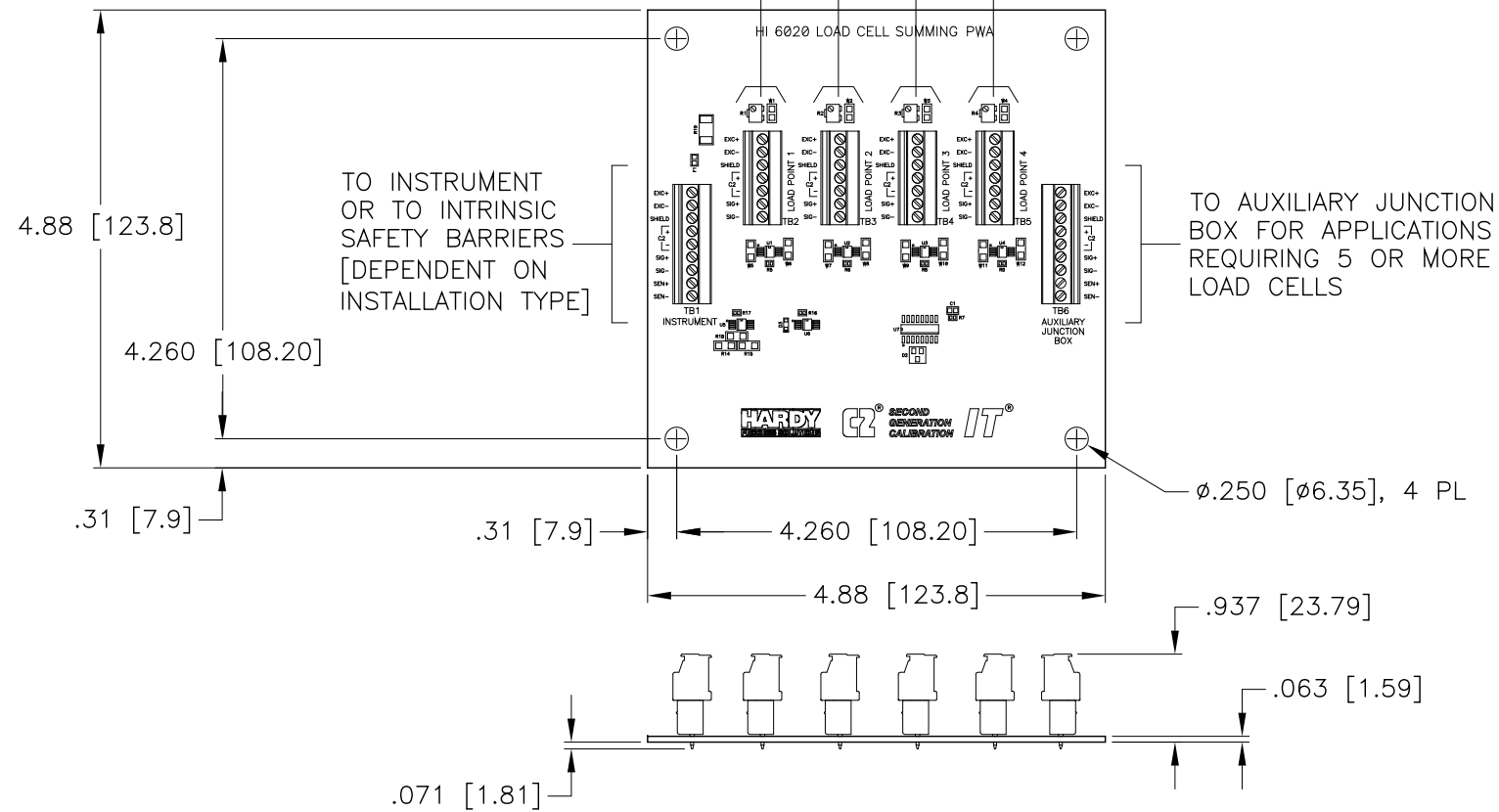

HI 6020IT SERIES LOAD CELL SUMMING CARD  
DIMENSIONS IN INCHES [MM]

- 7 OPTIONAL TRIM POTS CANNOT BE USED WITH C2 LOAD SENSORS.
6. SEE SHEET 2 FOR ENCLOSURE MOUNTING DIMENSIONS.
5. REFER TO GENERAL CONTROL DRAWING 0594-0008 FOR HAZARDOUS AREA USAGE GUIDELINES AND SYSTEM INTERCONNECT INFORMATION.
- 4 INSERT C2 LOAD CELL CABLE THROUGH GRIP FITTING AND TIGHTEN ON CABLE AREA MARKED GRIP ZONE. ALIGN END OF GRIP FITTING TO COMPLETELY COVER CABLE GRIP ZONE.
- 3 THE FOLLOWING PARTS ARE PLACED IN A BAG AND SHIPPED INSIDE THE JUNCTION BOX.

ITEM	PART NUMBER	QTY	DESCRIPTION
1	2814-0095-0	6	1/2 NPT NYLON LOCK NUT
2	6007-0097-0	6	1/2 NPT UL TYPE 4X NYLON CORD GRIP, $\phi$ .17 [ $\phi$ 4.3] - $\phi$ .45 [ $\phi$ 11.4]
3	2454-0009	6	1/2 NPT LIQUID TIGHT HOLE PLUG

2. USE HARDY PROCESS SOLUTIONS CERTIFIED LOAD CELL CABLE MODEL NO. C2 CABLE [PN 6020-0001-0].
1. REFER TO LOAD CELL CAL SHEET OR WEIGHING ASSEMBLY SELECTION GUIDE FOR LOAD CELL WIRING COLOR CODE.

### NOTES: UNLESS OTHERWISE SPECIFIED

**PROPRIETARY NOTICE**  
ALL DATA AND INFORMATION CONTAINED IN OR DISCLOSED BY THIS DOCUMENT IS CONFIDENTIAL AND PROPRIETARY INFORMATION OF HARDY PROCESS SOLUTIONS INC. AND ALL RIGHTS THEREIN ARE EXPRESSLY RESERVED. BY ACCEPTING THIS MATERIAL THE RECIPIENT AGREES THAT THIS MATERIAL AND THE INFORMATION CONTAINED THEREIN IS HELD IN CONFIDENCE AND IN TRUST AND SHALL NOT BE USED, COPIED, REPRODUCED IN WHOLE OR IN PART, NOR ITS CONTENTS REVEALED IN ANY MANNER TO OTHERS, EXCEPT TO MEET THE SPECIFIC PURPOSE FOR WHICH IT WAS DELIVERED.

## MODEL NUMBERS 7

HI 6020IT-SS1-6	DESCRIPTION
BLANK	= WITHOUT EXPANSION PORT
6	= WITH EXPANSION PORT
1	= WITHOUT TRIM POTS
2	= WITH TRIM POTS
SS	= STAINLESS STEEL ENCLOSURE

## CABLE CONNECTION 3

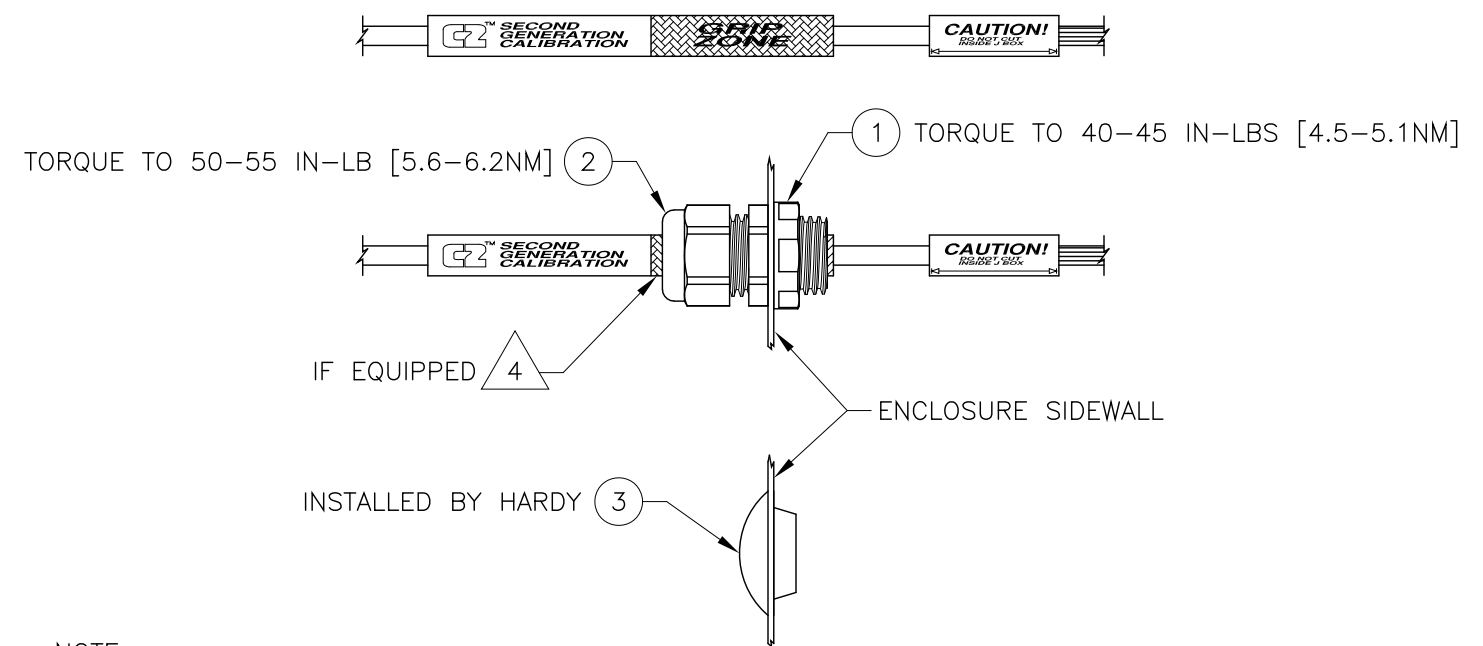

### NOTE:

FOR CLASS I, II, III DIV. 2 APPLICATIONS, THE CABLE GLAND SET PROVIDED WITH THE UNIT ARE NOT ACCEPTABLE. THE CUSTOMER IS RESPONSIBLE FOR REPLACING THE CABLE GLAND SET WITH THE APPROPRIATE CONDUIT FITTINGS TO MEET THE HAZARDOUS AREA REQUIREMENTS. WIRE PER LOCAL ELECTRICAL CODE.

ITEM	QTY	PART NUMBER	DESCRIPTION	COMMENTS
PARTS LIST				
UNLESS OTHERWISE SPECIFIED DIMENSIONS IN INCHES [MM]		CONTRACT NO. I/I DIAGRAM, HI 6020IT-SS SERIES		
TOLERANCES:		APPROVALS		
FRACTIONS: N/A		DRAWN V. CHULA DATE 02-24-17		
DECIMALS: .XX = $\pm$ .03 [.8]		CHECKED E. JAMES DATE 03-16-17		
.XXX = $\pm$ .010 [.25]		APPROVED V. CHULA DATE 03-16-17		
ANGLES: $\pm$ 0°, 30'		ISSUED V. CHULA DATE 03-16-17		
MATERIAL		PRODUCTION DATE		
FINISH		DO NOT SCALE DRAWING		
SIZE	FSCM	DRAWING NO.	REV.	
D	21316	0584-0101	C	
FILE NAME: 584101B1.DWG		SCALE: NONE	SHEET 1 OF 2	

HI 6020IT-SS1 SERIES  
 HI 6020IT-SS2 SERIES  
 (STAINLESS STEEL ENCLOSURE)

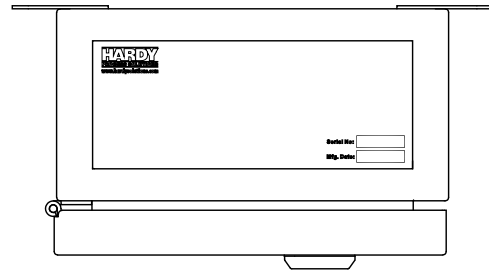

QUARTER-TURN LATCH WITH  
 .17 [1.8] X .62 [15.7] X  
 .15 [4.0] DEEP KEY SLOT

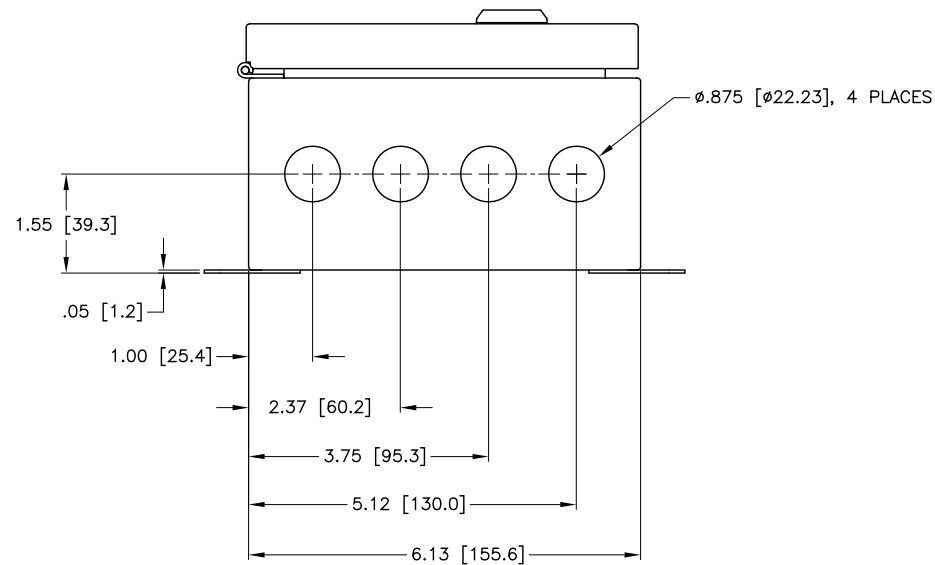
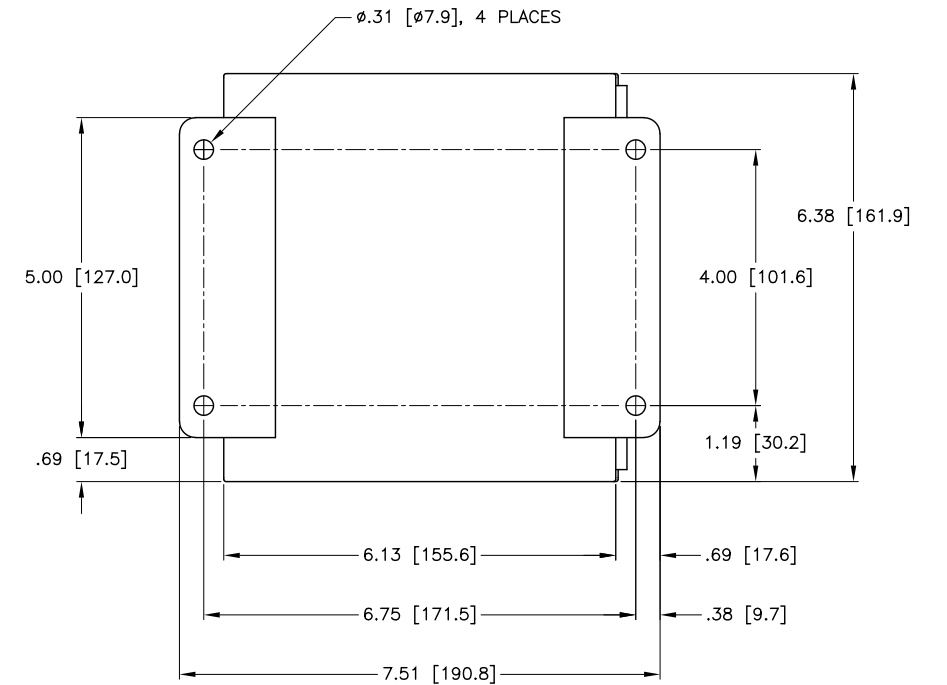
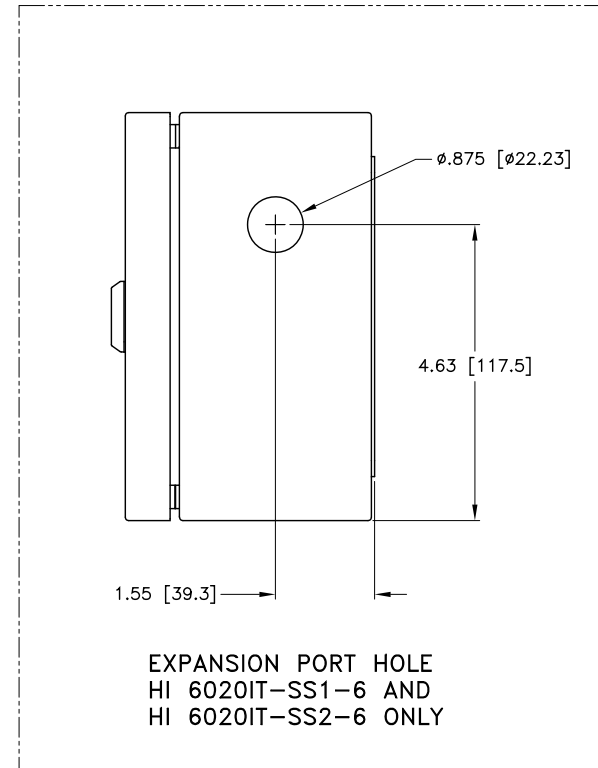
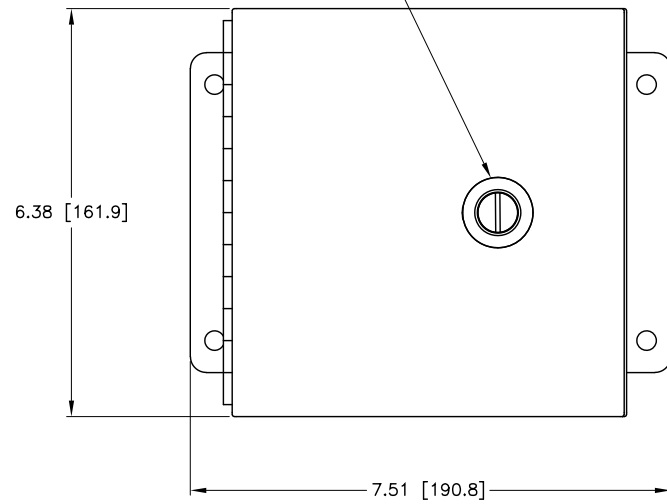
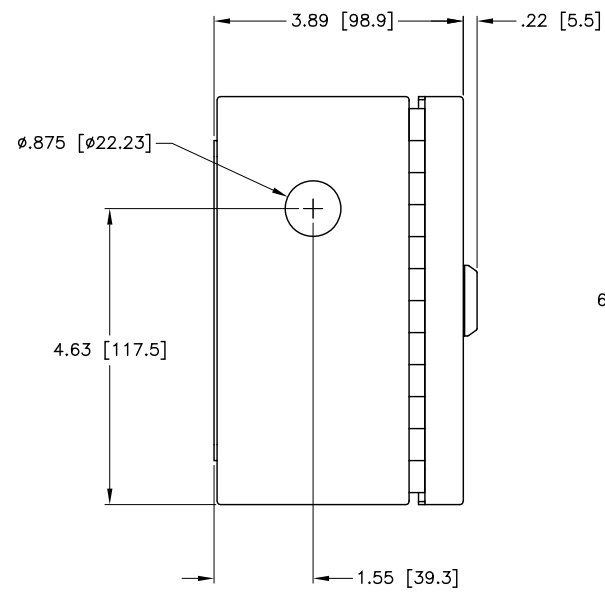

DIMENSIONS IN INCHES [MM]

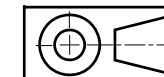

<b>HARDY</b> PROCESS SOLUTIONS			
TITLE I/I DIAGRAM, HI 6020IT-SS SERIES			
SIZE	FSCM	DRAWING NO.	REV.
D	21316	0584-0101	C
FILE NAME: 584101B1.DWG		SCALE: NONE	SHEET 2 OF 2